

LED Light / LED Traffic Light 890 / Accessories

## Vocal alarm WM 24VDC GY



Part No.: 190.020.55



### MECHANICAL DATA

|                              |                                     |
|------------------------------|-------------------------------------|
| Width                        | 127 mm                              |
| Height                       | 169 mm                              |
| Diameter                     | 150 mm                              |
| Materials                    | PC/ABS                              |
| Housing colour               | Grey                                |
| Protection category          | IP65                                |
| Connection                   | Screw terminals                     |
| cross-sectional area maximum | 1,50mm <sup>2</sup> / 16AWG         |
| Cable entry                  | Rubber pinch<br>Screwed cable gland |
| Cable entry minimum          | d = 6 mm                            |
| Cable entry maximum          | d = 12 mm                           |
| Tension relief               | Present (conforms to VDE)           |
| Type of fixing               | Wall mounting                       |
| Working temperature minimum  | -20°C                               |
| Working temperature maximum  | +55°C                               |
| Weight with packaging        | 979 g                               |
| Product weight               | 909 g                               |

### ELECTRICAL DATA

|                             |                    |
|-----------------------------|--------------------|
| Operating voltage           | 24V                |
| Operating voltage type      | DC                 |
| Operating voltage tolerance | +/- 10%            |
| Rated operational voltage   | 24 VDC             |
| Rated operational current   | 1500 mA            |
| Rated inrush current        | 6 A                |
| Protection class            | Protection class 2 |
| Pollution degree            | 3                  |

### OPTICAL DATA

|                      |                 |
|----------------------|-----------------|
| Service life optical | 5,000 h minimum |
|----------------------|-----------------|

### ACOUSTIC DATA

|                             |                 |
|-----------------------------|-----------------|
| Volume (max) at 1m distance | 110,0 dB (A)    |
| Acoustic service life       | 5,000 h minimum |

### APPROVAL DATA

|                              |     |
|------------------------------|-----|
| Conforms with CE             | Yes |
| Conforms with RoHS directive | Yes |
| WEEE                         | Yes |



For additional installation and mounting information, refer to the appropriate user guide at [www.werma.com](http://www.werma.com). This printed copy is for information only and is subject to alteration.

LED Light / LED Traffic Light 890 / Accessories

## Vocal alarm WM 24VDC GY

|                               |                       |
|-------------------------------|-----------------------|
| Conforms with ATEX-directive  | No                    |
| Conforms with CCC             | No                    |
| Conforms with UL              | No                    |
| Conforms with FCC             | No                    |
| Conforms with IC              | No                    |
| EAC certificate available     | Yes                   |
| Conforms with UKCA (Importer) | Yes (WERMA (UK) Ltd.) |
| Conforms with CMIM            | No                    |
| Conforms with AS-I            | No                    |
| ICAO Certification            | No                    |
| Conforms with DNV             | No                    |
| Conforms with RoHS CN         | No                    |
| Conforms with VdS             | No                    |

### DRAWING

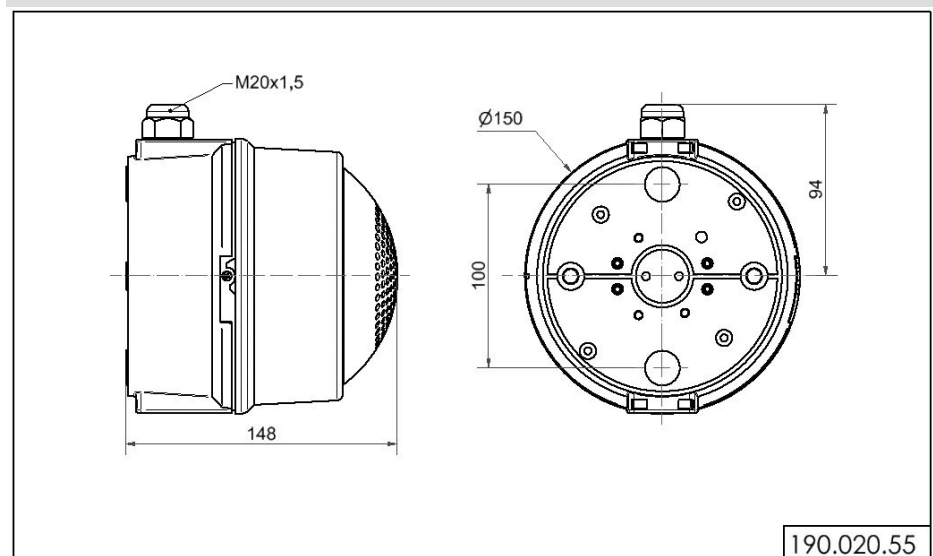

For additional installation and mounting information, refer to the appropriate user guide at [www.werma.com](http://www.werma.com). This printed copy is for information only and is subject to alteration.