

Obstruction lights / LED Obstruction light 281

LED Obstruction light BM 12-50VDC RD



Part No.: 281.410.55



MECHANICAL DATA

| | |
|------------------------------|-----------------------------|
| Height | 205 mm |
| Diameter | 165 mm |
| Materials | Aluminium Glass |
| Dome colour | Clear |
| Housing colour | Black Red |
| Protection category | IP66 IP68 |
| Connection | Screw terminals |
| cross-sectional area maximum | 1,50mm ² / 16AWG |
| Cable entry | Screwed cable gland |
| Cable entry minimum | d = 9 mm |
| Tension relief | Present (conforms to VDE) |
| Type of fixing | Base mounting |
| Working temperature minimum | -30°C |
| Working temperature maximum | +50°C |
| Weight with packaging | 2229 g |
| Product weight | 1997 g |

ELECTRICAL DATA

| | |
|-----------------------------|--------------------|
| Operating voltage | 12-50V |
| Operating voltage type | DC |
| Operating voltage tolerance | +/- 0% |
| Rated operational voltage | 24 VDC |
| Rated operational current | 500 mA |
| Rated inrush current | 2.000 mA |
| Protection class | Protection class 1 |
| Pollution degree | 3 |

OPTICAL DATA

| | |
|----------------------|------------------|
| Light source | LED |
| Light colour | Red |
| Optical signal image | Permanent |
| Intensity | >10cd |
| Service life optical | 50,000 h maximum |

APPROVAL DATA

| | |
|------------------------------|-----|
| Conforms with CE | Yes |
| Conforms with RoHS directive | Yes |



For additional installation and mounting information, refer to the appropriate user guide at www.werma.com. This printed copy is for information only and is subject to alteration.

Obstruction lights / LED Obstruction light 281

LED Obstruction light BM 12-50VDC RD

| | |
|-------------------------------|----------------------------|
| WEEE | Yes |
| Conforms with ATEX-directive | No |
| Conforms with CCC | No |
| Conforms with UL | No |
| Conforms with FCC | No |
| Conforms with IC | No |
| EAC certificate available | Yes |
| Conforms with UKCA (Importer) | Yes (WERMA (UK) Ltd.) |
| Conforms with CMIM | No |
| Conforms with AS-I | No |
| ICAO Certification | Yes (Low Intensity Type A) |
| Conforms with DNV | No |
| Conforms with RoHS CN | No |
| Conforms with VdS | No |

DRAWING

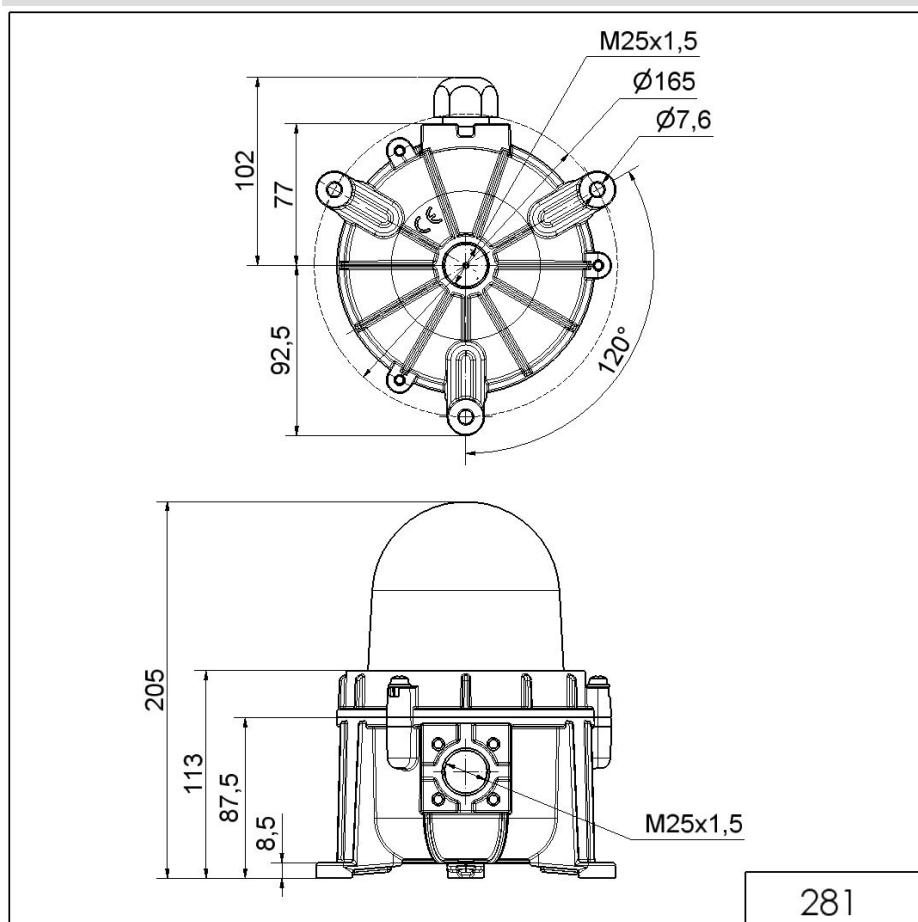

For additional installation and mounting information, refer to the appropriate user guide at www.werma.com. This printed copy is for information only and is subject to alteration.